

ROC-556™

OPERATORS MANUAL



⚠️ WARNING

Before using this suppressor; be certain you thoroughly read and understand the product manual. Failure to follow all operating, installation, cleaning and maintenance instructions before using the suppressor, could result in serious injury or death.

If you are at all uncertain about any of the operations or instructions outlined in the manual, HALT right there and hit up Siege Customer Service before moving forward! A digital copy of the manual in PDF format can be downloaded at no cost by visiting: WWW.SIEGESUPPRESSORS.COM/MANUALS/



REV 2.2

SIEGE BULLET-PROOF LIFETIME WARRANTY

You're probably bracing for a bunch of legalese, but at Siege, our warranty is refreshingly simple:

**"IF A SIEGE SUPPRESSOR PRODUCT EVER LETS YOU DOWN OR GIVES YOU TROUBLE, WE'VE GOT YOUR BACK. WE'LL FIX IT OR REPLACE IT - FREE, NO QUESTIONS ASKED."
- SIEGE MANAGEMENT**

Reach out to our Service Department to receive a Return Merchandise Authorization (RMA) and a free prepaid shipping label to send the suppressor to us for evaluation.

**VISIT US AT SIEGESUPPRESSORS.COM
866.467.4343 | INFO@SIEGESUPPRESSORS.COM**

PROUDLY DESIGNED &

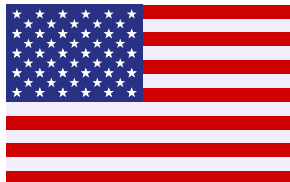

MADE IN OREGON U.S.A.

GENERAL DESCRIPTION

Siege Suppressors feature a modern, seamless design achieved through advanced manufacturing techniques and proprietary bonding processes. Siege Suppressors excel in sound and flash suppression, durability, and are self-cleaning, with reduced back pressure. Their design uses a Linear Diffuser Array to efficiently direct and expel propellant gasses, lead, copper, and carbon, minimizing fouling and enhancing performance. Unique to Siege Suppressors is a contiguous bore design, which enhances erosion resistance by avoiding angular barriers and allowing gasses to flow smoothly, unlike traditional baffled suppressors.

SPECIFICATIONS

| | |
|--------------------------|---|
| Model | ROC-556™ |
| SKU | ROC556-BLK, ROC556-FDE |
| Caliber | 5.56x45mm NATO (or smaller) |
| Mounted Length | 7.65 in |
| Diameter | 1.5 - 1.6 in |
| Mounted Weight | 18.06 oz |
| Materials | Precipitation Hardening SS & Inconel |
| Finish | Nitride |
| Full Auto Rated | Yes |
| Min Barrel Length | 10 in |

THE FOUR RULES OF GUN SAFETY

Nobody likes a "Range-Nazi", but we've found these simple, no-nonsense safety rules work well to keep everything running safe for all your shooting applications:

- 1. All guns are always loaded. Even when they are not, treat them as if they are.**
- 2. Never let the muzzle cover anything you are not willing to destroy.**
- 3. Keep your finger off the trigger till your sights are on the target.**
- 4. Identify your target, and what is behind it.**

Suppressor HUB / Universal Mount

Feeling lost in the suppressor mount maze? Whether you're a newbie or a Pro, we're here to guide you through. Let's cut through the noise and clarify the jargon. Here's the lowdown:

- Suppressor "HUB" or "HUB Mount" - HUB stands for Hybrid Universal Base.
- Suppressor "Universal Mount" - Different name, but the same game.

A Suppressor HUB / Universal Mount is a mounting adapter system, integrated into the rear of a suppressor. The system utilizes a mechanical threaded socket and is industry standardized at 1- $\frac{3}{8}$ " \times 24. That's 1.375" diameter and a pitch of 24 threads per inch.

Why Go HUB/Universal?

HUB/Universal threads free you from the shackles of brand-specific mounting systems, letting you utilize existing mounting systems that you might already own. Gone are the days of being locked into a single company's muzzle device and suppressors. Now, you have the flexibility to customize your setup however you like. The specific parts of the HUB are shown in Figure 1.

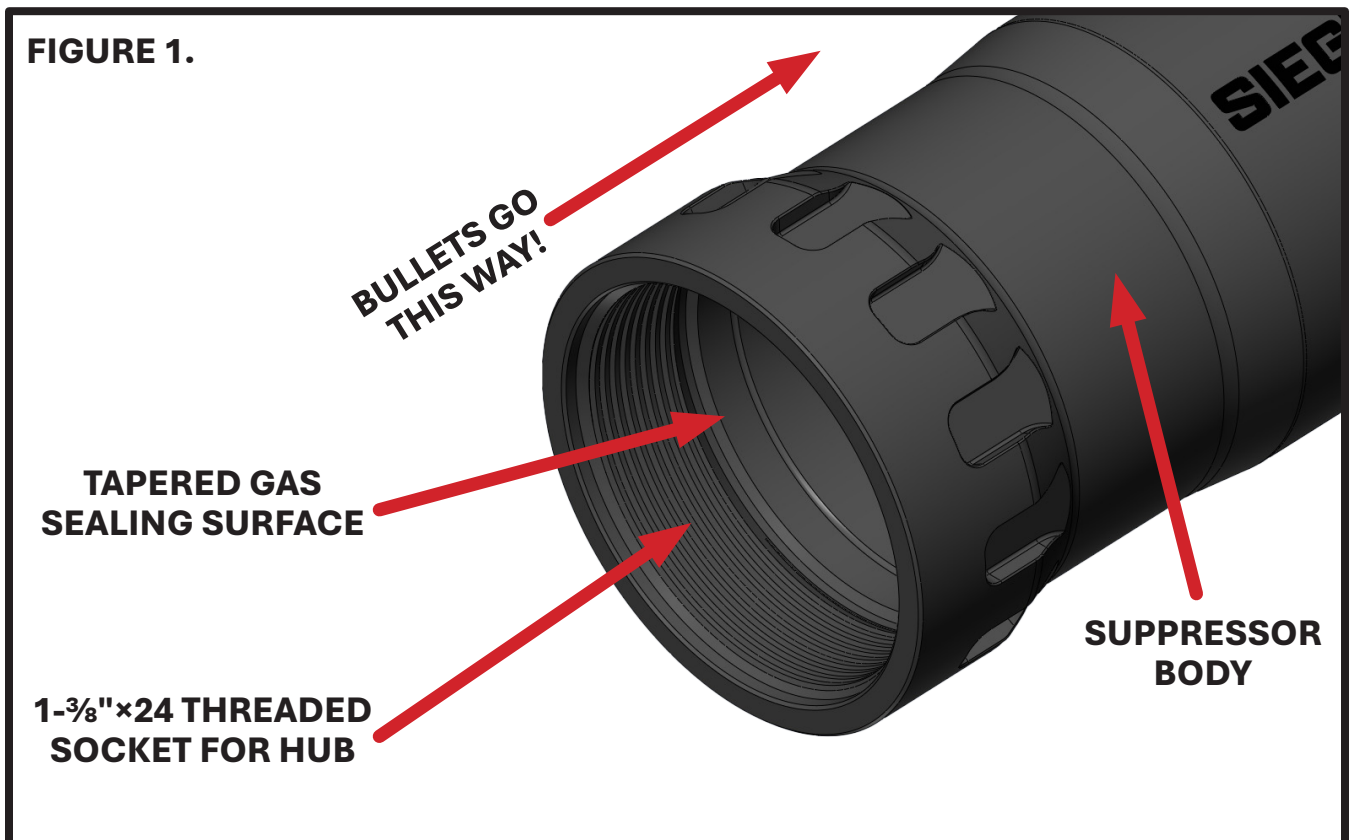

THE SIEGE OmniHex™ WRENCH FLAT SYSTEM

In an industry first our Direct-Thread Mount utilizes the Siege OmniHex™ System. This allows the alternate use of multiple wrenches on the same hex wrench flats. The outward facing side of the mount allows the use of either the Siege Universal Wrench, a standard $\frac{3}{4}$ " open ended-wrench or a $\frac{7}{8}$ " open-ended wrench. The Siege Universal Wrench will allow fitment to any diameter barrel, but if you're stuck with regular box end wrench a $\frac{3}{4}$ " will get you to 0.74" diameter, and $\frac{7}{8}$ " will get you to 0.874".

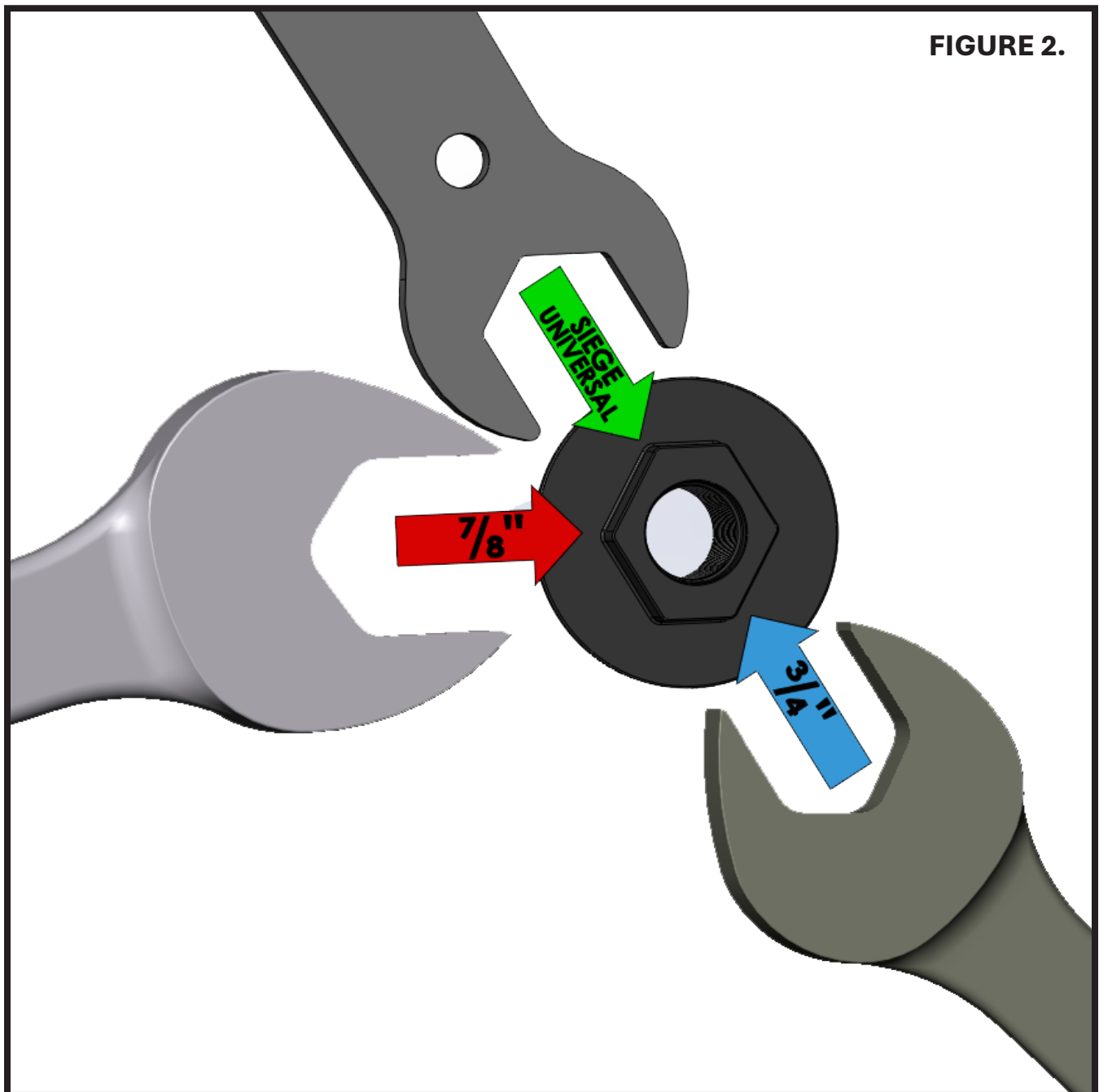

INSTALLING THE SIEGE DIRECT THREAD MOUNT

- ⚠️ Only make changes to you suppressor when it's not mounted to a firearm. Failure to do so could result in serious personal injury or death.
- ⚠️ Before using third-party direct-thread adapters with the ROC-556, it is the user's responsibility to verify full compatibility. Please consult the installation and removal instructions provided by the adapter manufacturer. The following guidelines only cover the installation and usage of Siege designed direct-thread adapters and may not be applicable t third-party products.

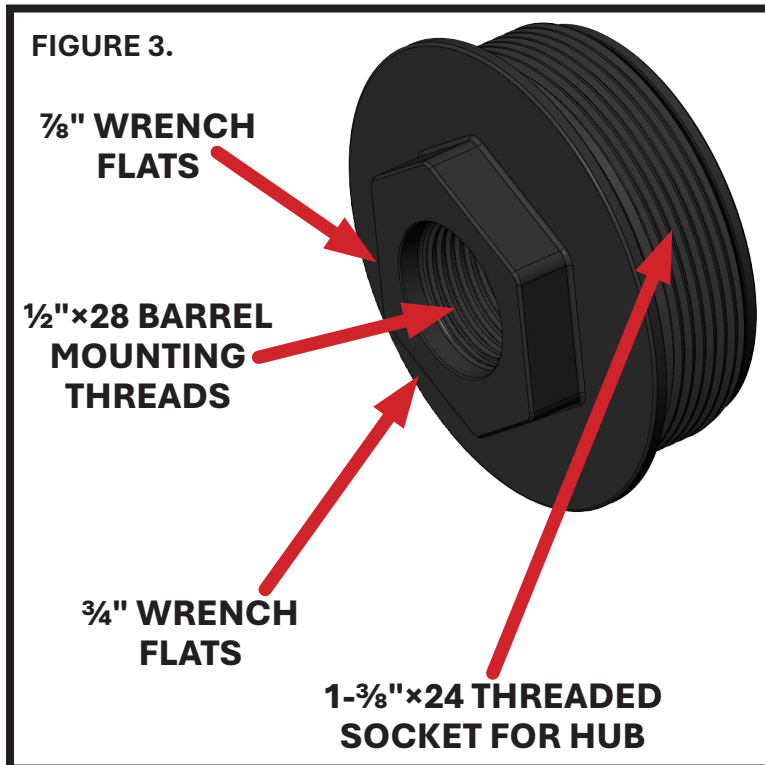

STEP 1. Check that the mount's 1-3/8"×24 socket threads are clean & in good order. (see Figure 3.)

Locate the supplied Siege Universal Wrenches that came with your suppressor. You can also use one Siege Universal Wrench and either a 3/4" or 7/8" open end wrench. Utilize the spanner end of one of the Siege Universal Wrenches to hold the suppressor by engaging in the slots in the body, and second wrench on the Flat-Duo flats. (see Figure 6.)

STEP 2. Check that the HUB socket's 1-3/8"×24 threads are clean and in good order. (see Figure 4.) Apply a light coating of high-temperature grease or anti-seize compound to the socket threads. Our go-to is Loctite® LB 8036™ White Hi-Temp Anti-Seize. Like all anti-seize compounds once you get it on your hands it spreads like the plague to everything you touch. Using a cotton swab for application is a smart move.

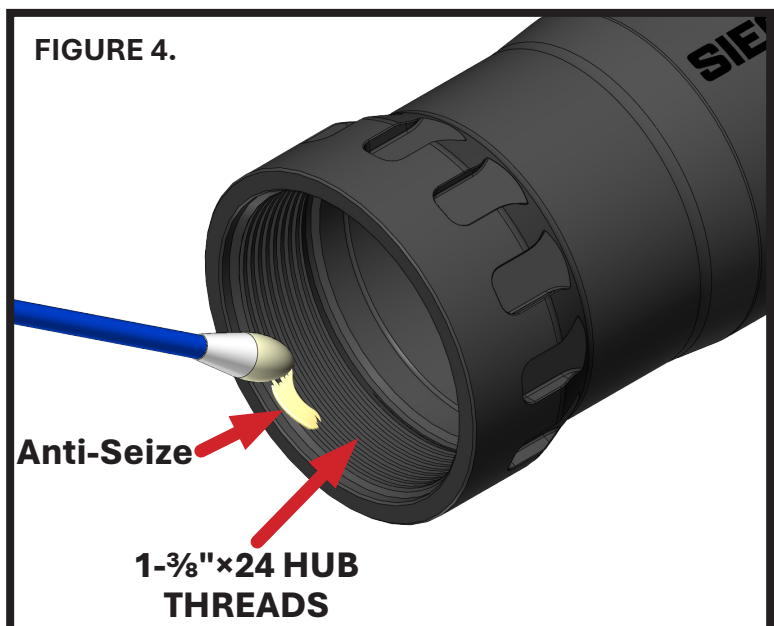
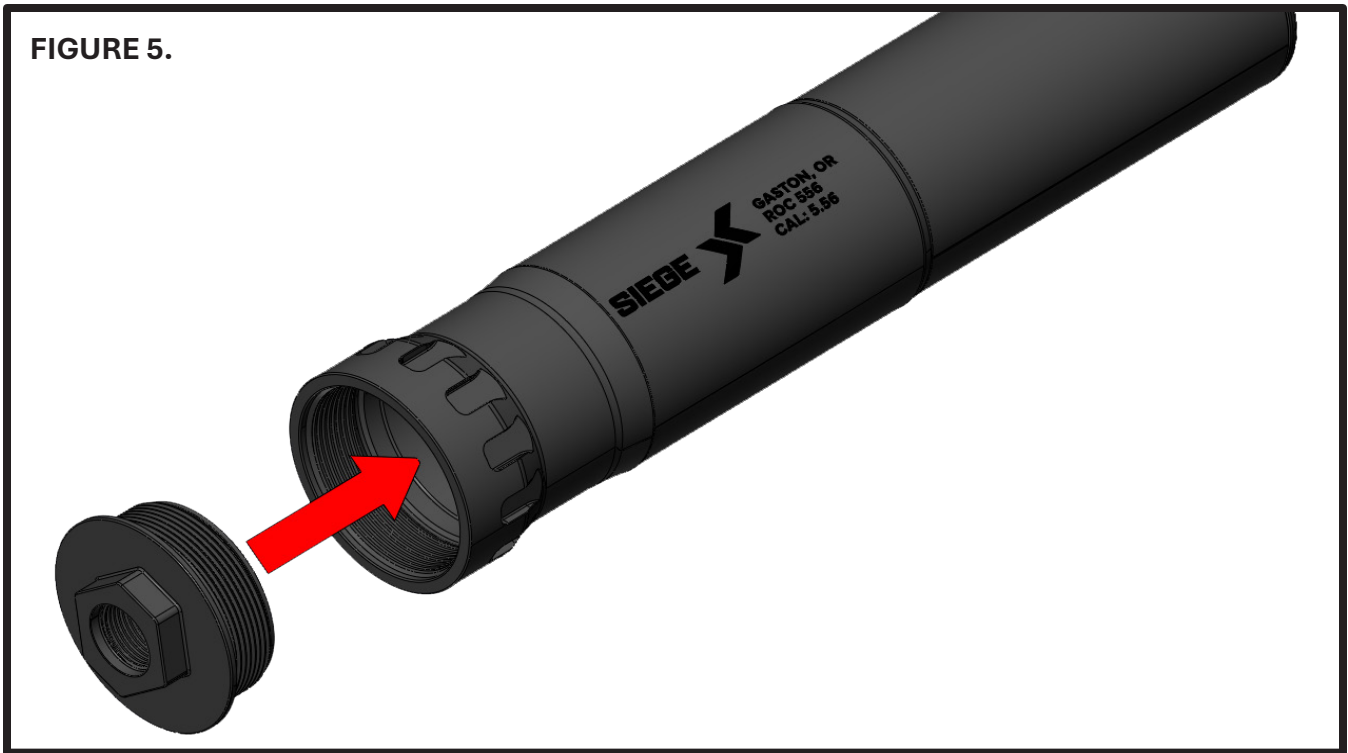
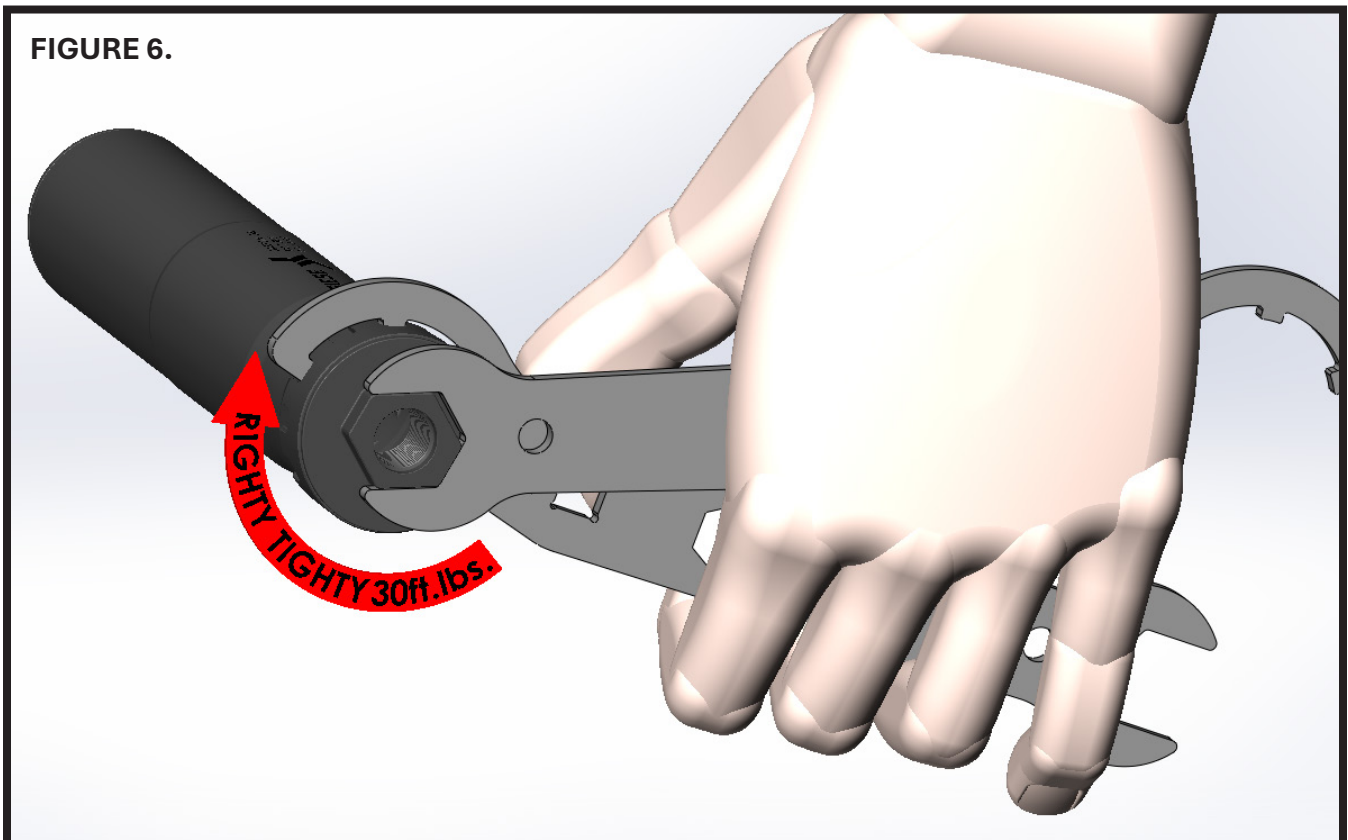

FIGURE 5.



Insert the Direct Thread Mount into the HUB socket (see Figure 5.), and start threading it in a clockwise direction by hand. It should turn freely with no resistance. If it does not want to screw in by hand HALT right there and hit up Siege Customer Service before moving forward! Utilize the spanner end of one of the two included Siege Universal Wrenches to engage the slots in the suppressor body, and second wrench to tighten the mount to 30 ft. lbs. (see Figure 6.)

FIGURE 6.



MOUNTING THE ROC-556™ ON YOUR HOST FIREARM

- ⚠️ ☠️ Before mounting the suppressor, unload and make safe as outlined in the operator's manual for your host firearm. Failure to do so could result in serious personal injury or death.
- ⚠️ Follow all safety procedures outlined in the operator's manual for your host firearm.
- ⚠️ Be familiar with the operation and handling characteristics of your host firearm.
 1. Remove any existing muzzle devices from the intended host weapon. Make sure to remove and not re-use any existing shims or crush washers etc.
 2. Visually check the threads for any damage or burrs that may prevent the installation of the mounting device. If damage is observed, have it seen to by a competent gunsmith.
 3. Clean the muzzle threads, making sure to remove any debris, previous thread adhesives or oils. This is best done with a cleaning solvent like acetone blown off with compressed air, then applying a light coating of gun oil such as Break Free® CLP®.
- ⚠️ Host firearm muzzle threads must be ½"×28. We recommend using a host with threads that meet or exceed **SAAMI spec THREAD & SOCKET DRAWINGS: .500-28-UNEF-2A ≤.225 BORE DIAMETER.**
- 4. Insert the suppressor onto the host weapon (see Figure 7.) muzzle threads & screw on by hand in a clockwise direction. If it does not want to screw on by hand HALT right there & hit up Siege Customer Service before moving forward!

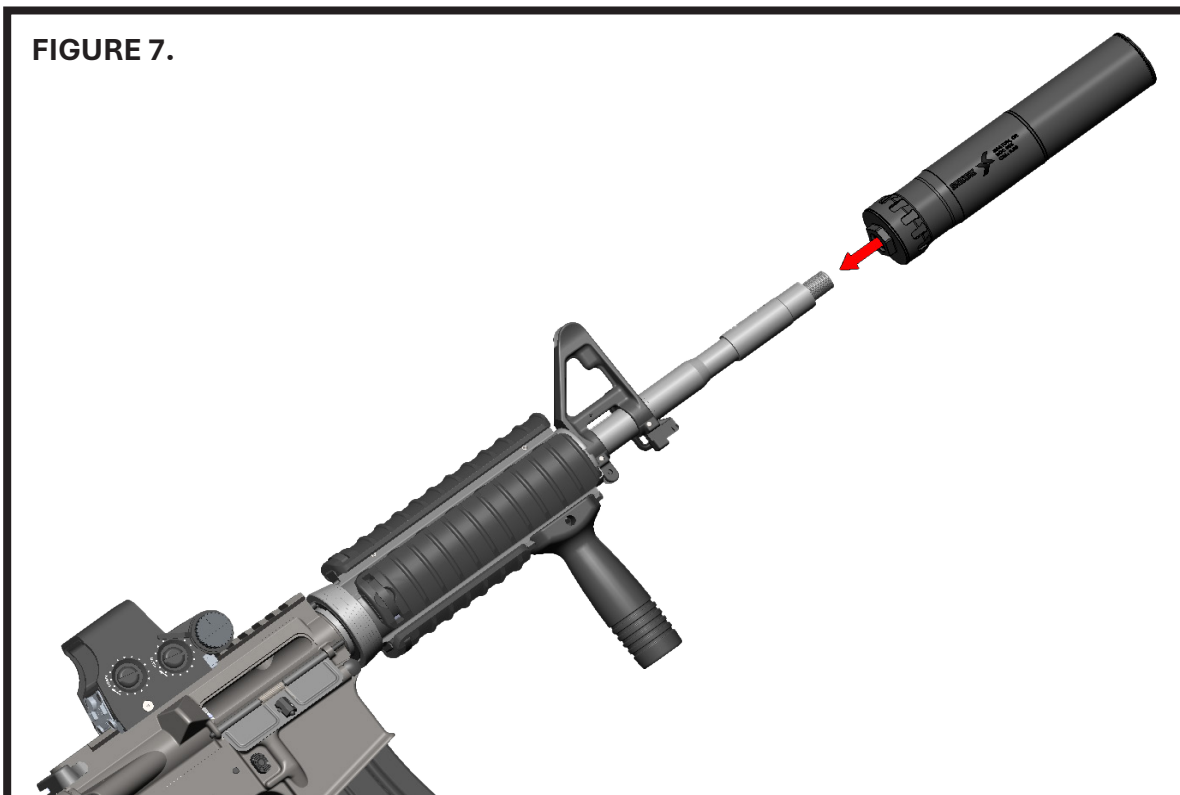
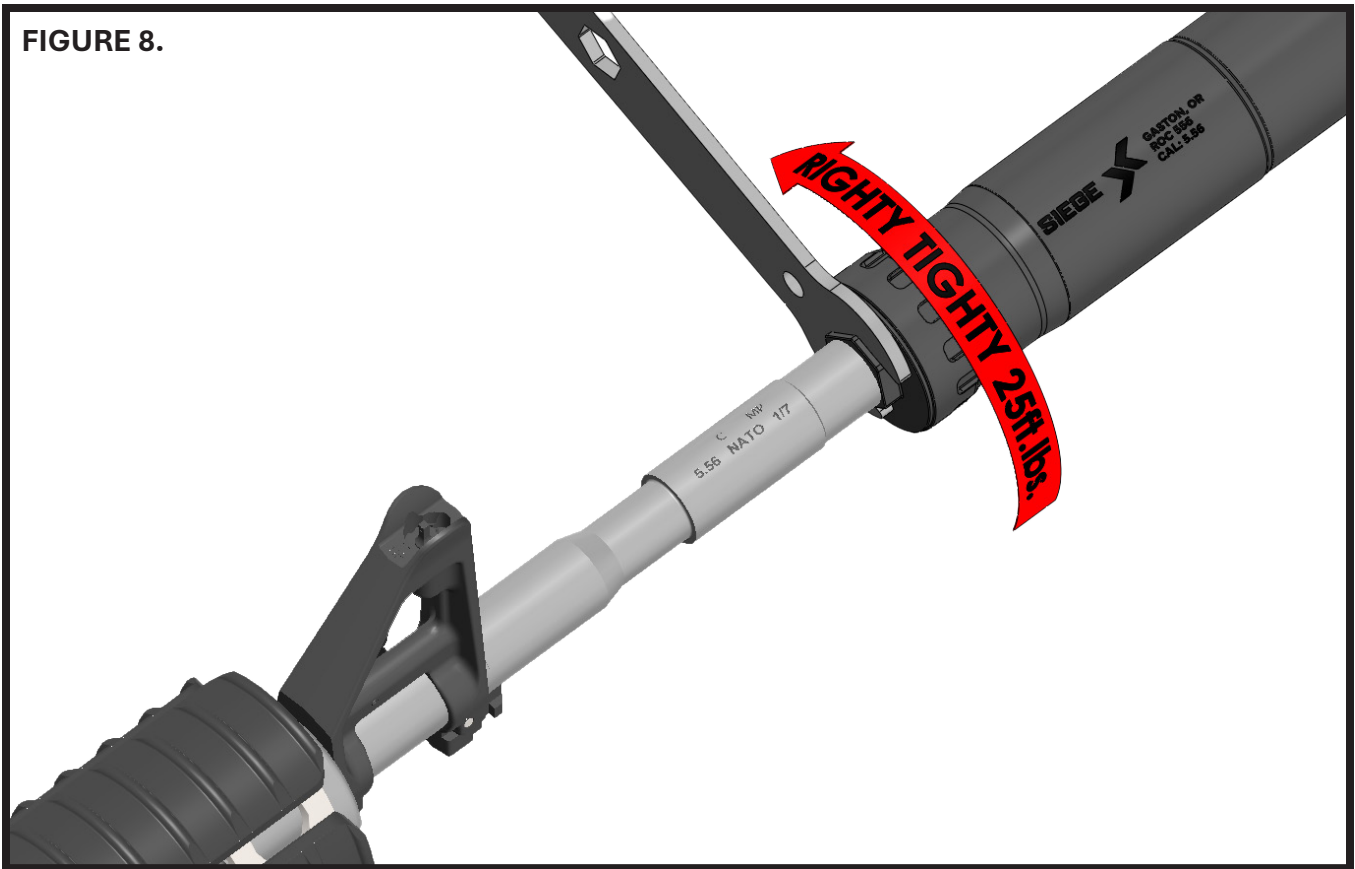

FIGURE 8.



5. While supporting the rifle, tighten the suppressor using either the Siege Universal Wrench, a 3/4", or a 7/8" open end wrench. Torque to 25 ft. lbs.

- ⚠ In order to reduce the risk of a baffle strike, it is important to ensure that the host barrel threads are aligned concentrically with the barrel bore axis. If you do not have the means to verify this, we strongly recommended that you have a competent gunsmith verify if for you.
- ⚠ We recommend using a host firearm with muzzle threads that meet or exceed SAAMI spec THREAD & SOCKET DRAWINGS: .500-28-UNEF-2A ≤.225 BORE DIAMETER.
- ⚠ Always wear eye and ear protection when shooting.
- ⚠ Never install or remove a silencer onto or from a loaded host firearm.
- ⚠ Be sure the ROC-556 is securely mounted before discharging the host firearm.
- ⚠ The ROC-556 silencer and the host firearm barrel may become extremely hot during use. Wear heat-resistant gloves or allow the silencer and host firearm to cool before attempting to remove the silencer.
- ⚠ Only factory loaded SAAMI or C.I.P spec ammunition of the correct type for your firearm should be used. We recommend that only solid copper, bonded copper, jacketed or semi-jacketed bullets be used.

HexRescue™ SYSTEM

The Siege Direct-Thread Mount incorporates the useful HexRescue™ System. Ever had a mount come off inside of an AR platform handguard? The HexRescue™ allows you to use a standard 5/8" socket, a ratchet and a ratchet extension (not shown) if needed to get you out of trouble. The mount can be loosened and removed from down inside the handguard on short barrel guns set up in AR15 SD configuration.

FIGURE 9.

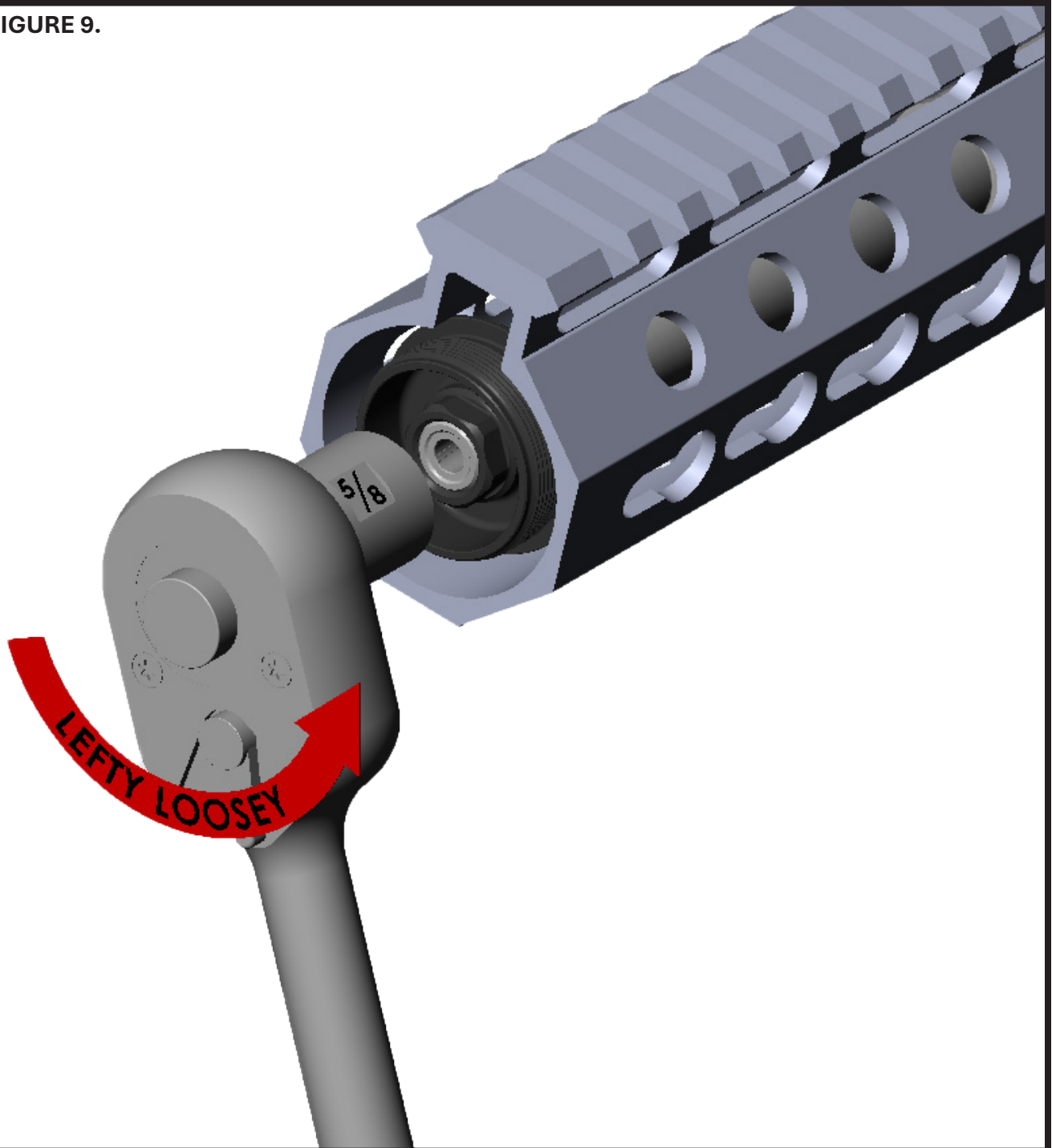

CLEANING & MAINTENANCE

⚠️ ☠️ Before performing any cleaning & maintenance, make sure to unload and make safe as outlined in the operator's manual for your host firearm. Failure to do so could result in serious personal injury or death.

⚠️ Make sure to use adequate PPE (Personal Protective Equipment) such as safety glasses and gloves while performing Cleaning & Maintenance.

When used with quality factory loaded SAAMI or C.I.P spec ammunition, the ROC-556's patented free-flowing internal design, is self-cleaning. The main areas of attention when cleaning, are the muzzle device (If not direct thread mounting), especially the threads and alignment taper and the threads and alignment taper in the silencer. Remove stubborn accumulated fouling from the accessible surfaces using a gun cleaning solvent and a blue nylon double end "All Purpose Cleaning Brush" (NSN:1005-01-578-9925) or similar and wipe clean. Applying a light coating of gun oil such as Break Free® CLP® for lubrication of the threads and taper.

If you're pushing the limits with heavy firing schedules or have a use case in or around salt water, we highly recommend use of Loctite® LB 8036™ White Hi-Temp Anti-Seize as a lubricant on the threads to aid in silencer removal and prevent galling.

